

# Emergency Range

Installation instructions for JC110001 Emergency Bulkhead



## Warnings & Cautions

- To avoid electric shock, serious injury or property damage, isolate power before installing, removing or servicing the product.
- It is recommended that luminaires are installed by a qualified electrician to ensure the installation complies with the local current wiring regulations.
- It may be necessary to upgrade your MCBs to allow for increased inrush current.
- This product is designed for connection to a 100-240V~ 50/60Hz.
- It is recommended that the ambient room temperature should not exceed 26°C.
- All testing should be carried out in accordance to EN 50172:2004
- The light source of this luminaire is not replaceable: when the light source reaches the end of its life the whole of the luminaire must be replaced.
- Read instructions and check that you have all of the tools and accessories required to complete the installation correctly. Isolate power supply before starting installation.
- Do not carry out insulation tests with the product connected to the circuit.
- Any broken or damaged parts should be replaced as soon as possible. JCC will not accept responsibility for claims arising from sub-standard installations; which will void the warranty.
- This luminaire is suitable for indoor and outdoor use.

## INSTALLATION

ENGLISH

3W 100-240V~ 50/60Hz - Class II

Colour temp: 7000K Ra: 84

Wire preparation: 1-2.5 mm<sup>2</sup>

Light source: Integral LED

Wattage:3W

Lumens: 120 lumens

**KEY:**  
**E: EARTH PROVISION**  
**N: NEUTRAL**  
**L: U/SWITCHED LIVE(in)**  
**L1: U/SWITCHED LIVE(out)**  
**L2:Sw/LIVE**

Maintained(3M)  
 + on/off Switched  
 + Emergency

E		E(provision only)
N		Neutral: Blue
L		U/sw Live(in): Black
L1		U/sw Live: (out)Black
L2		Sw/Live: Brown

Maintained(3M)  
 + Light on 24/7  
 + Emergency  
 (linked)

E		E(provision only)
N		Neutral: Blue
L		U/sw Live(in): Black
L1		U/sw Live(out): Black
L2		Sw/Live: Brown

Non-Maintained(3NM)  
 + Light off 24/7  
 + Emergency  
 (remove link)

E		E(provision only)
N		Neutral: Blue
L		U/sw Live(in): Black
L1		U/sw Live:(out) Black
L2		Sw/Live: (do not use)

- Remove the two screws holding the diffuser to gain access to the interior.
- Release the LED tray to access the mains input terminal by pressing the quick release tabs. This is hinged so the LED tray remains attached to the body.
- Cable entry is available through rear, top and bottom or both ends. Ensure appropriate grommets or compression couplings are used to maintain the IP65 rating where required.
- Connect the mains input supply as indicated on the above as per the required operation.
- Connect the emergency battery leads to the circuit board where indicated.
- Close the LED tray, ensuring it is secured using the securing tabs.
- Refit the diffuser ensuring there is a good seal to maintain the IP65 rating.
- Switch on mains supply and test for operation(allow 24hrs for batteries to charge). Charging and normal operation is indicated when the green light is on
- Fit the legends on the front of the diffuser to suit the application from the three choices indicated on the right which are included.
- Familiarise yourself with the enclosed emergency fittings test record sheet and ensure it is completed as required and left with the end user.

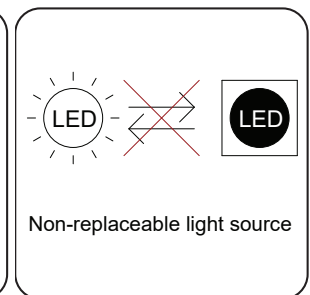
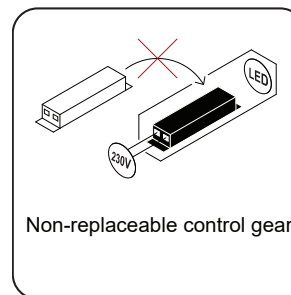
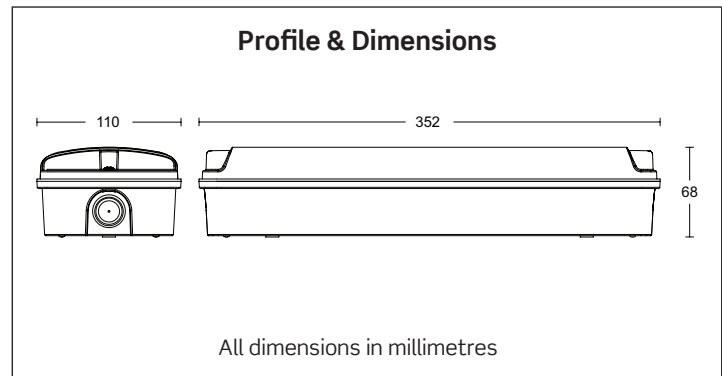
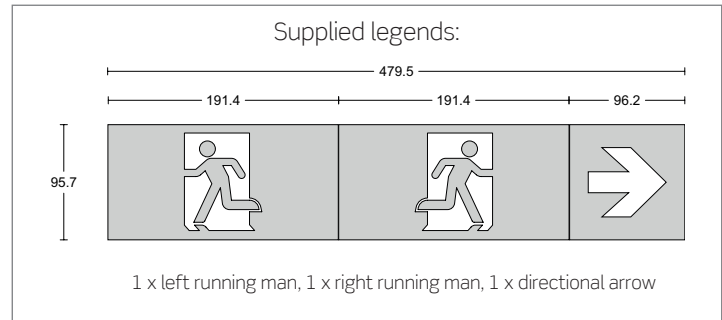

CE UK RoHS Compliant IP65 [jcc.co.uk](http://jcc.co.uk)

## Important warranty information

This product is supported by a 2-year standard warranty which will extend to 5 years if registered within the first year of purchase. (5 year on batteries). Please register at [jcc.co.uk/warranty](http://jcc.co.uk/warranty) - Terms and conditions apply.

The installer will be asked to provide the following information, which is detailed on a label attached to the luminaire's chassis:  
 Product Code/Date Code.

BS EN ISO9001 - 2015 - Registered Firm Certificate No. GB 1552

JCC Lighting Products Ltd. Innovation Centre, Beeding Close, Southern Cross Trading Estate, Bognor Regis, West Sussex, PO22 9TS, United Kingdom

Technical Support: +44(0)1243 838986 Customer Services: +44(0)1243 838999

V4\_August\_2021\_RS

